

# ***John Samuels Archaeological Consultants***

*The Manor, South Street, Normanton on Trent, Newark, Nottinghamshire NG23 6RQ  
Telephone 01636 821727 Fax 01636 822080*



**A Report on an Archaeological Evaluation**

**at**

**The Church of St Mary Magdalene, Keyworth, Nottinghamshire**

**(NGR SK 6135 3087)**

**Prepared on behalf of**

**The Rector and Parochial Church Council**

**of**

**St Mary Magdalene Church, Keyworth, Nottinghamshire**

**SUMMARY**

***JSAC 205/97/002***

**September 1997**

---

***Also at : Witham Park House, Waterside South, Lincoln LN5 7JP Telephone 01522 880050***

***Summary***

*It is proposed that an extension to St Mary Magdalene Church, Keyworth, Nottinghamshire be built. In advance of this work the Southwell Diocesan Advisory Committee required that an archaeological evaluation be undertaken. John Samuels Archaeological Consultants were appointed to undertake this work. A specification for an archaeological evaluation was submitted by John Samuels Archaeological Consultants and this was subsequently approved by the Archaeological Advisor to the Southwell Diocesan Advisory Committee (JSAC205/97/001).*

*Three evaluation trenches were excavated by hand to a depth of 1.10 metres, mainly through made-up ground. These deposits appeared to be the result of landscaping, possibly in the late 19<sup>th</sup> century. No features of archaeological importance were identified although a number of grave cuts were noted.*

*The excavation was carried out to the prescribed depth without encountering any significant archaeological remains and within the agreed timescale.*

### **3.0 Results**

- 3.1 All trenches were 1m x 1.5 m in plan and excavated to a depth of 1.10 m. The area of evaluation was all contained within a raised area of the church yard on the northwest side of the church. It is believed that this area has been landscaped in relatively modern times.
- 3.2 Trench A : Twenty five centimetres beneath the topsoil mortared brick work [020] was encountered. On excavation this was found to be the side walls of a brick lined burial vault. The whole of the vault was filled with a dark brown clayey silt which contained large quantities rubble material [017]. At the limit of excavation, 1.10 m, the surface of a small coffin [019] was exposed, possibly the burial of a child. The coffin was made of lead but had some wood adhering to its surface, indicating that this may originally have been a wooden coffin with a lead lining. The coffin was not disturbed during excavation.
- 3.3 Trench B : Within this trench 3 grave cuts were identified [06] [08] [09], no human remains were recovered in any of the grave cuts. The absence of human remains may be attributable to them having been removed during landscaping; as the fill of the grave cuts comprised redeposited materials.
- 3.4 Trench C : Beneath a covering of 0.25m of darkgrey/black clayey silt topsoil were three distinct redeposited soils [013] [014] [015]. These are believed to be the result of relatively modern landscaping activity.

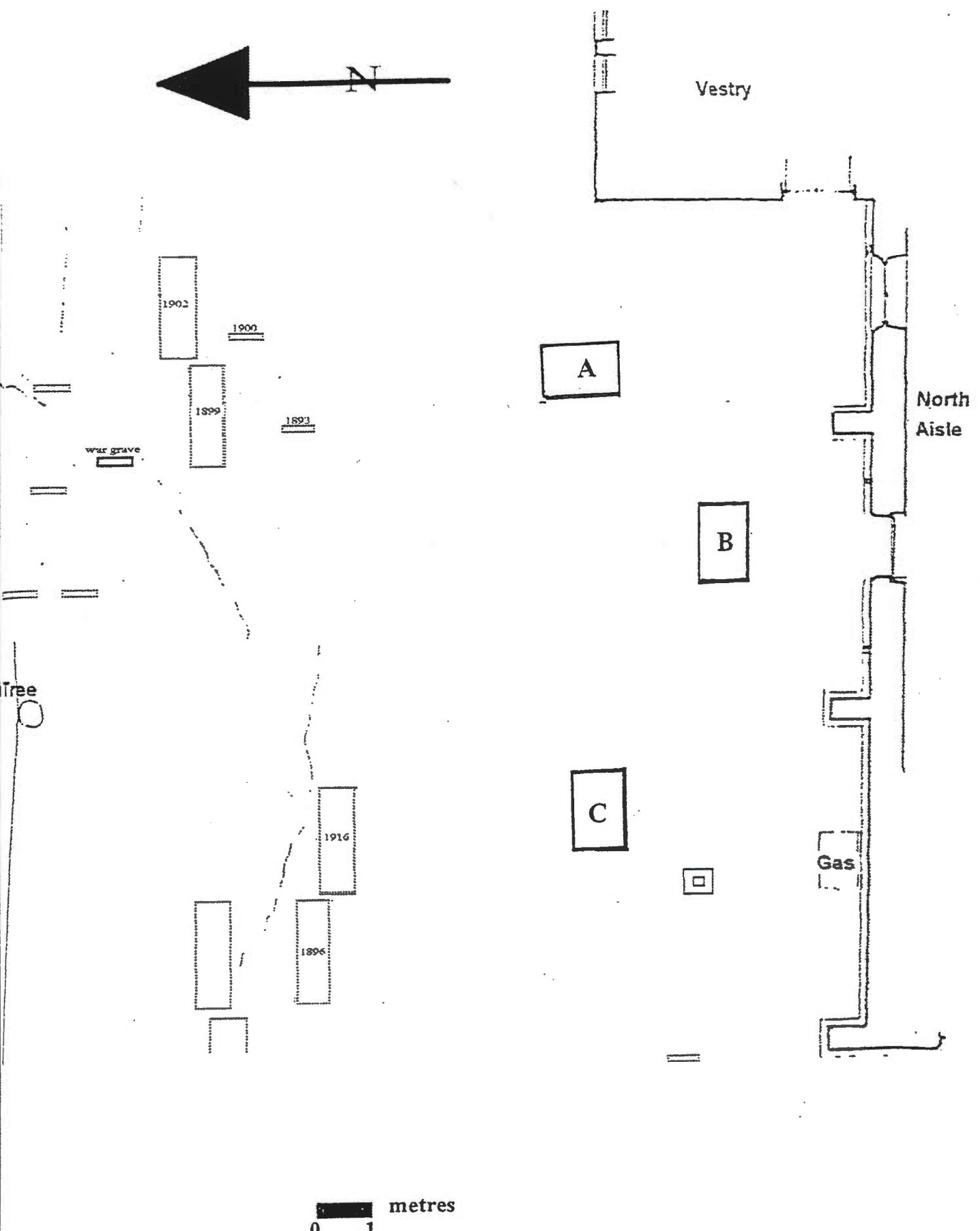

metres  
0 1

The Church of St Mary Magdelane  
Keyworth, Nottingham.  
NGR SK 6135 3087  
*jsac 136/97/002*

Not to Scale

Figure 2 : Location of Excavation

The Church of St Mary Magdalene  
Keyworth, Nottinghamshire.  
NGR SK 6135 3087  
*jsac 136/97/002*

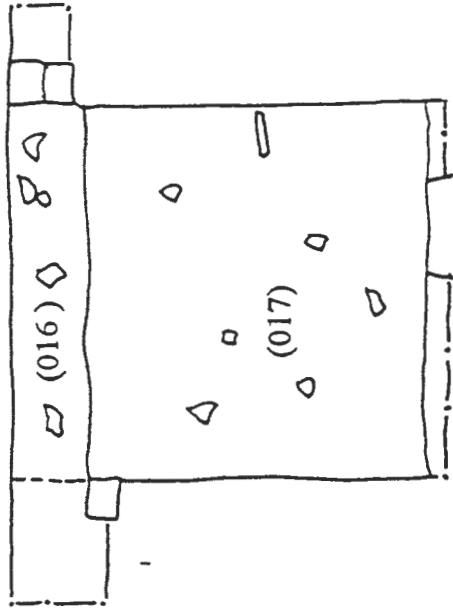

W SECTION OF EXCAVATION A

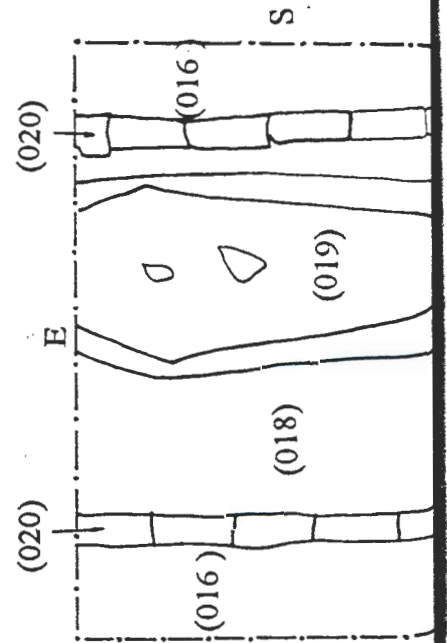

PLAN OF EXCAVATION A .N

The Church of St Mary Magdalene  
 Keyworth, Nottinghamshire.  
 NGR SK 6135 3087  
 jsac 136/97/002

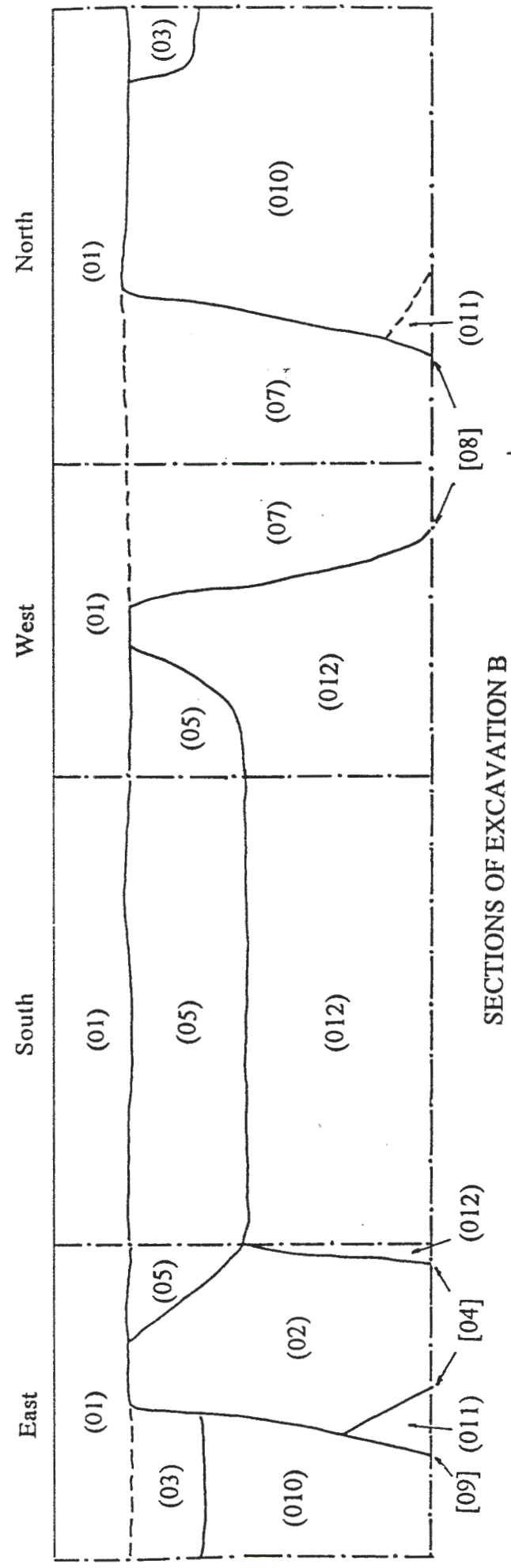

SECTIONS OF EXCAVATION B

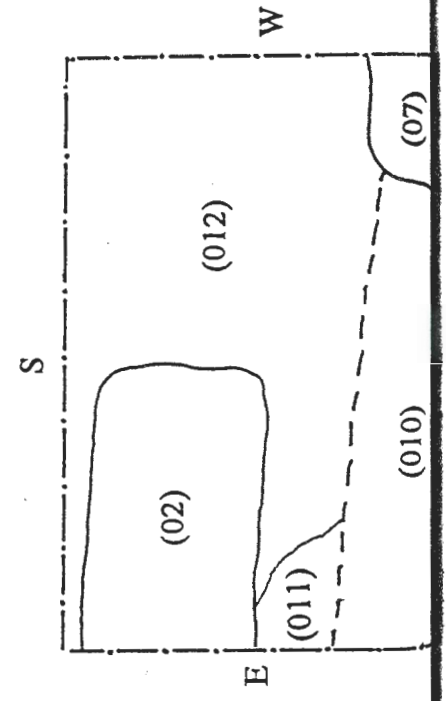
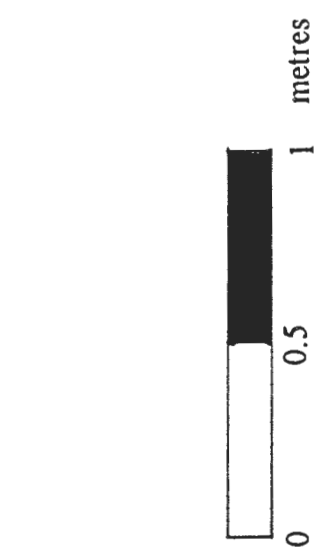

PLAN OF EXCAVATION B

The Church of St Mary Magdalene  
Keyworth, Nottinghamshire.  
NGR SK 6135 3087  
jsac 136/97/002

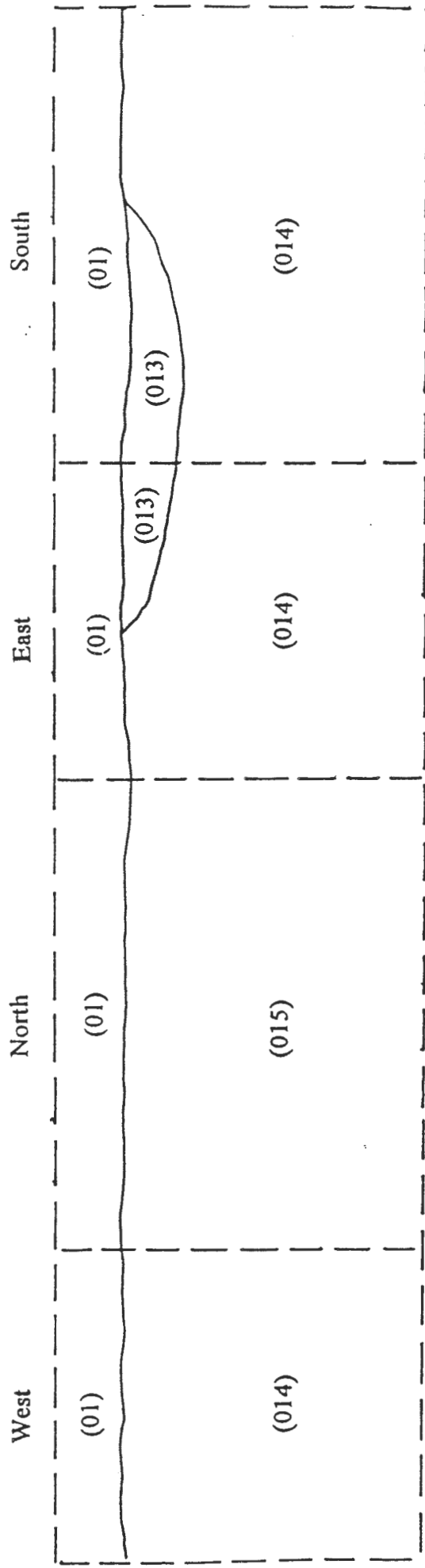

SECTIONS OF EXCAVATION C

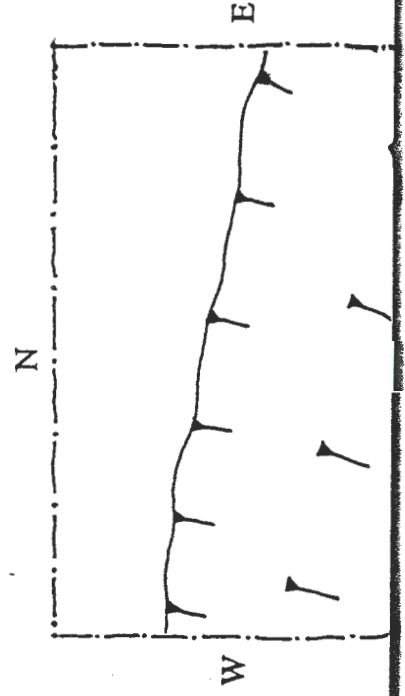

PLAN OF EXCAVATION C

