

RECEIVED 1 0 OCT 1997

John Samuels Archaeological Consultants

The Manor, South Street, Normanton on Trent, Newark, Nottinghamshire NG23 6RQ

Telephone 01636 821727 Fax 01636 822080



The Church of Saint Katherine,
Teversal, Nottinghamshire
An Archaeological Watching Brief

Produced by

John Samuels Archaeological Consultants

for

Sir Charles Nicholson Group
1a Peveril Drive,
The Park,
Nottingham.
NG7 1DE

JSAC/233/97/001

July, 1997

Also at: Witham Park House, Waterside South, Lincoln LN5 7JP Telephone 01522 880050

3.0 Results

Summary:

A nineteenth century brick burial vault was found in soakaway 1. A possible grave cut was found in soakaway 2. No further archaeological features were present in any of the other excavations. The soakaways were very disturbed. A quantity of disarticulated human bone was recovered from each of the soakaways and from one drain, that running north from soakaway 3.

3.1 Soakaway 1

Location: North side of church

Dimensions: 1.5 x 1.75m

Max depth: 1.2m

Features: Brick burial vault. The west end of the vault was uncovered at the westernmost end of the soakaway trench. The north side was also exposed. The base of the vault was at a greater depth than the base of the soakaway trench. The vault was a structure of 3" machine made bricks of an irregular bond, mortared together. It had a barrel vaulted roof over which was a layer of levelled mortar containing pieces of limestone, c.0.20 in diameter. This layer was covered by a thin layer of light coloured gravel, c.0.10m thick, which was in turn overlaid by a layer of black asphalt. The topsoil which covered the asphalt was c.0.10m deep. There was no associated gravestone, or any related features visible on the present ground surface. To the east of the soakaway was a fill of local stone part of which overlay the north east corner of the vault (photo 2). In the western section was a void towards at a depth of 0.80m. This was interpreted as the end of a grave cut.

Finds: Human bone (disarticulated), 1 cows tooth, 1 beer bottle top, 2 shards blue and white transfer printed earthenware, 1 shard post medieval lead glazed earthenware, 1 shard medieval green glazed pot.

Drain 1

Location: Running south west from soakaway 1

Features: None

Finds: None

Drain 2

Location: Running south east from soakaway 1

Features: None

Finds: None

Soakaway 2

Location: South west side of church

Dimensions: 1.4 x 1.3m

Max depth: 1.40m

Features: One the end of a cut feature which was rectangular in section was noted at the east side of the soakaway at a depth of 0.80m. An interpretation could not be made because little of the feature was revealed. The soil was disturbed throughout the trench.

Finds: Human bone (disarticulated), 1 fragment mortar, 1 fragment mortar with adhering plaster, 1 shard post medieval glass, 2 fragments clay pipe stem, 1 modern ceramic bottle stopper, 1 shard post medieval lead glazed earthenware, 1 shard medieval pottery.

Drain 1

Location: Running north east from soakaway 2

Features: None

Finds: None

Drain 2

Location: Running south east from soakaway 2

Features: None

Finds: None

Soakaway 3

Location: South east side of church

Dimensions: 1.0 x 1.4m

Max depth: 1.40m

Features: None - heavily disturbed soil throughout the trench

Finds: Human bone (disarticulated) 1 clay pipe stem fragment.

Drain 1

Location: Running south west from soakaway 3

Features: None

Finds: None

Drain 2

Location: Running north from soakaway 3

Features: None

Finds: Disarticulated human bone

3.5 Conclusions

- 3.5.1** The watching brief revealed one structure, a nineteenth century burial vault on the north side of the church. The creation of this feature will have destroyed any earlier archaeological remains within the immediate area. It will almost certainly have destroyed the stratigraphic relationship between the exterior of the north aisle wall and the churchyard at this point. No other features were discovered. The finds were all post medieval in date and none were stratified.
- 3.5.2** The human bone discovered was all disarticulated. It was mostly recovered from heavily disturbed layers in soakaways 2 and 3. A small quantity of bone was recovered from soakaway 1. The bone was returned to the incumbent for reburial.

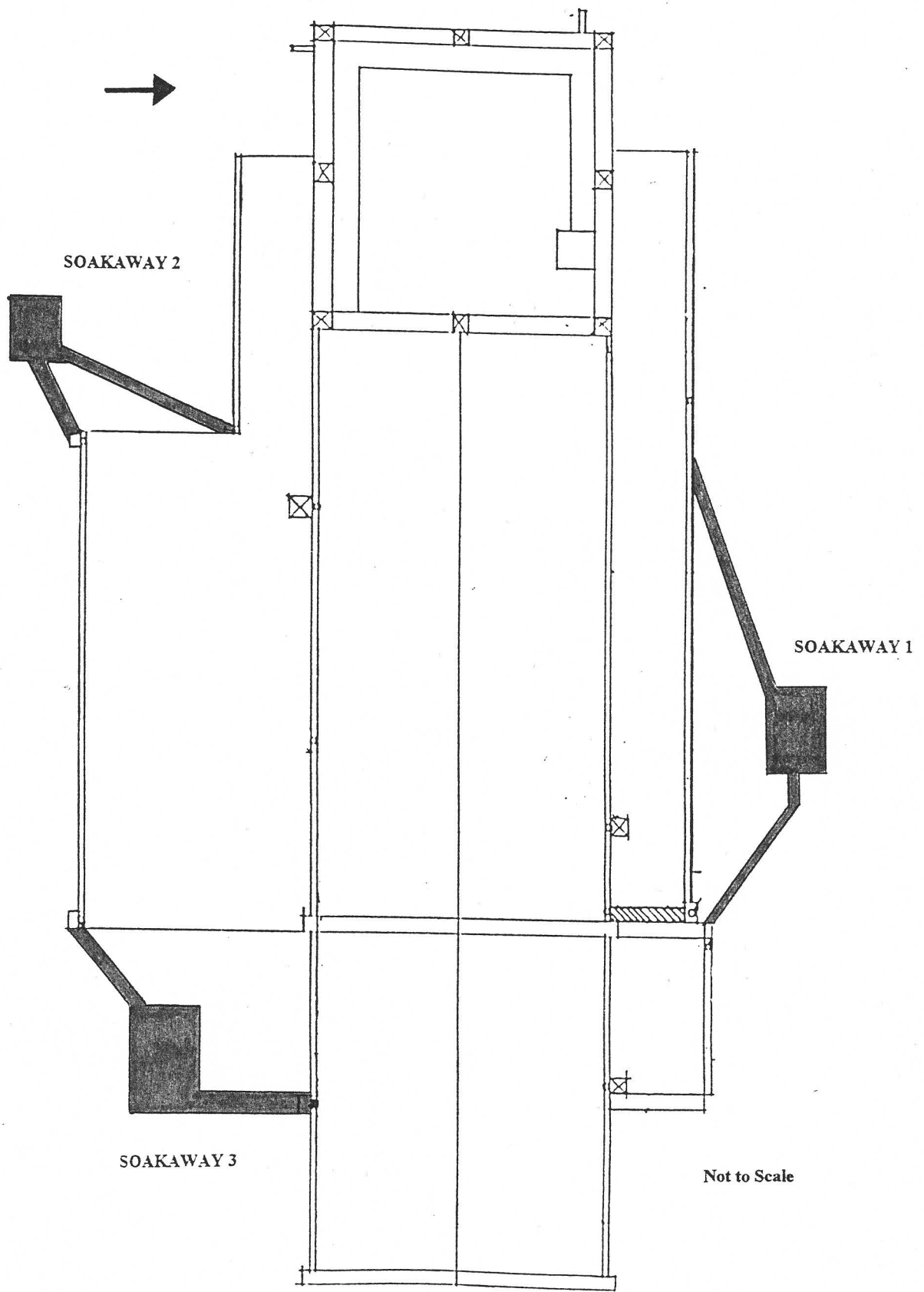

Fig 2: Trench Locations